

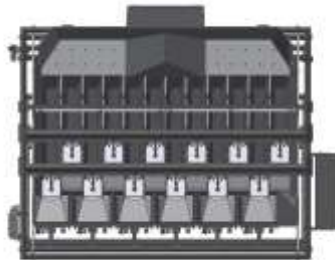

# Weightronic XL-Series

Linear high speed multi-head weigher  
for

Large and Extra Large Potatoes, Onions, Citrus and Similar Products



## Weightronic XL-Series

- Robustly constructed in stainless steel and clean design
- 10 or 12 Weigh Heads
- Siemens PC ET200SpOpenController with 12“ color touch Panel
- Space saving compact design (staggered weighing buckets)
- Gentle product handling with low drops
- Fully automatic infeed control
- Automatic taring
- Capable of running with one or more channels disabled
- Count by weight, minimum weight or average weight programmes
- Counting function with photocells as option
- Easy to combine with one or more packaging machines
- 25kg (50lbs) in single drop
- Extra large weighing buckets (297x252x250mm)
- Simply cleaned

## Weightronic XL-Series

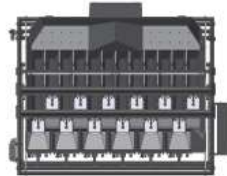

The ILAPAK Weightronic **1200 XL** in Stainless Steel Design for Agricultural Products like Onions and Potatoes is a Siemens PC controlled Multiheadweigher with **12 XL** staggered Weighing Buckets. Each of the 10,0 l Buckets is working in combination with the other buckets to weigh the product accurate. The best available combination will be released by the weigh buckets.

### Machine Finish

Stainless Steel and Clean Design, Vibratory Magnets IP65

### Machine Frame

Made of tubular stainless steel material in an open frame clean design separate (not mounted to the machine) Rittal Control Cabinet

### Load Cells and Weighing Buckets

Highspeed Stainless Steel Load Cells in IP 68  
Weighing Buckets, staggered design, 10,0 l, Dimensions 297 x 252 x 250mm

### Elektronic Components

Siemens-PC with 12" Color-Touch-Screen  
Profinet-Interface  
Remote Maintenance via integrated EWON VPN Router  
Menu Navigation in multiple languages  
Operator Friendly Design  
3 password secured Operator Levels  
100 Programmes storable  
Software Modus for Single and Multiple Drops  
Individual Programming for vibration time and frequency for optimal product flow

## Weightronic XL-Series



## Weightronic 1000 XL

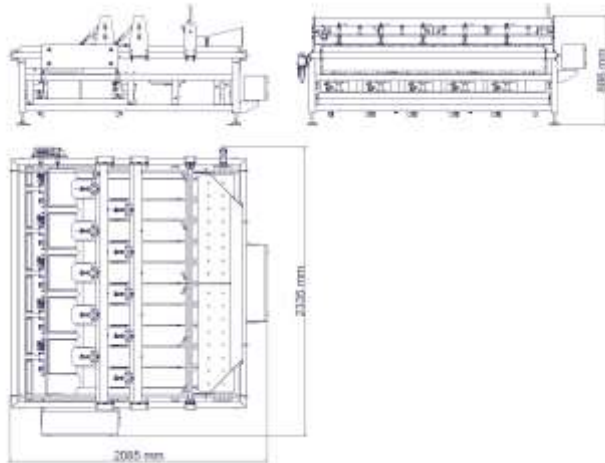

### Standard Equipment:

- Stainless Steel and Clean Design
- Vibrations Channels angled
- Weighing Bucket Size (297x252x250mm)
- Stainless Steel IP 68 load cells
- Siemens PC with 12" Color Touch Panel

### Technical Data:

- Up to 12 drops at 20 kg; dep. on product
- 230/400 V/N/PE; 50/60Hz; approx. 1.2 KW
- Weight: approx. 650kg
- Package Size: 1.0 – 20kg; >20kg multiple drops; dep. on product

## Weightronic 1200 XL

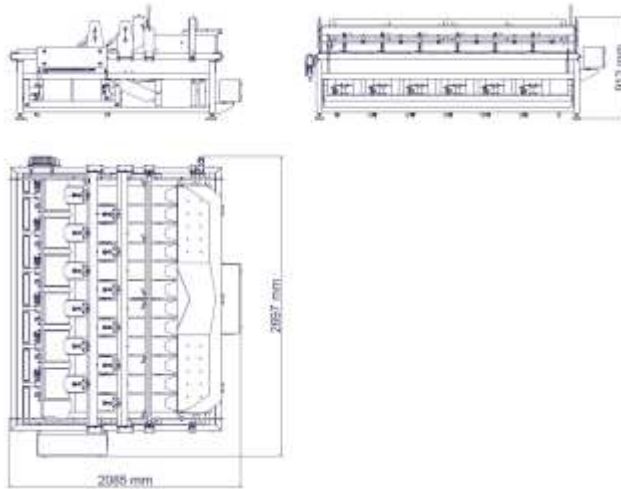

### Standard Equipment:

- Stainless Steel and Clean Design
- Vibrations Channels angled
- Weighing Bucket Size (297x252x250mm)
- Stainless Steel IP 68 load cells
- Siemens PC with 12" Color Touch Panel

### Technical Data:

- Up to 15 drops at 25 kg; dep. on product
- 230/400 V/N/PE; 50/60Hz; approx. 1.4 KW
- Weight: approx. 700kg
- Package Size: 1.0 – 25kg

## Main Discharge Systems XL-Series



- **Cross-Conveyor left or right direction**

### **Change-Over Flap**

- **2 conveyors – bi-directional**
- **1 collector at the end of each conveyor**